

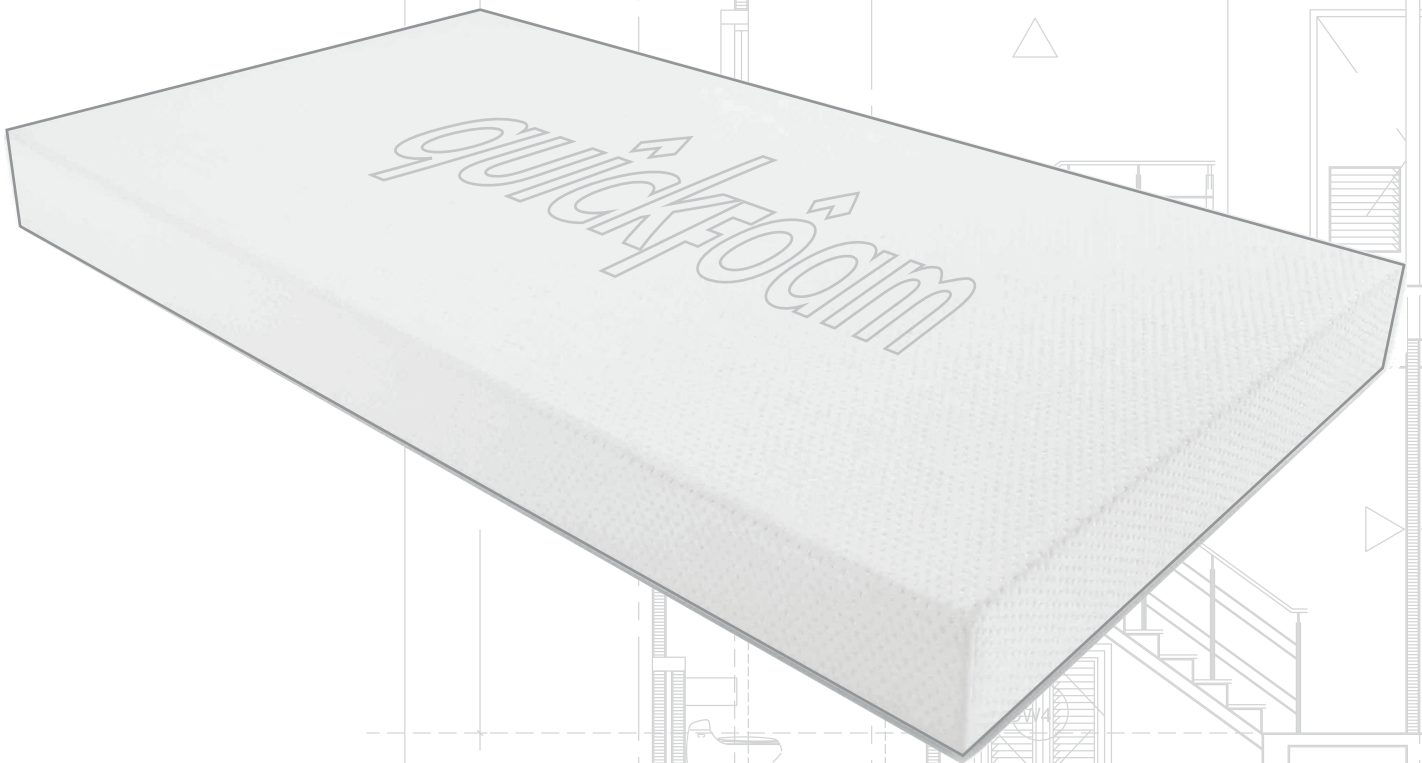

quickfoam



Data Sheet



quickfôam

quickfôam Technical Sheet



quickfôam

quickfôam It's a polystyrene sheet
High density expanded, supplied in
different thicknesses and sizes and cut
according to the needs of the project

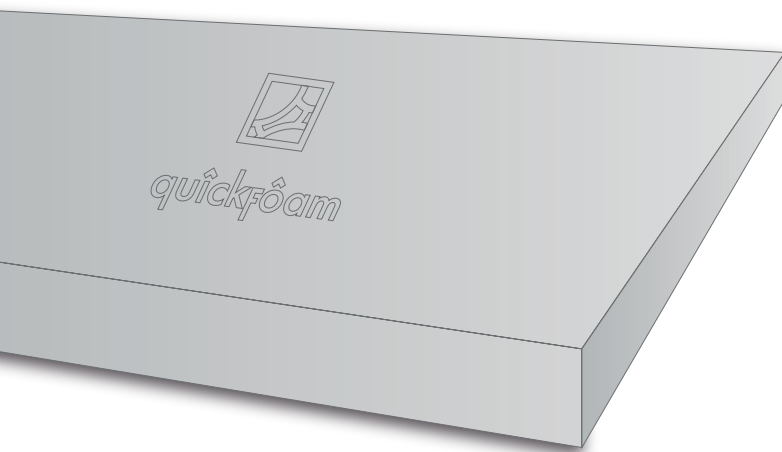



Technical properties of EPS

Tensile strength	≥ 150 Kpa					
Reaction to fire*	SE					
Reaction to fire of the construction system**	B-s1,d0					
Resistencia a la compresión al 10% de deformación	≥ 100 Kpa					
Dimensional stability in specific conditions (70°C - 90%HR)	L 0% / A 0% / E -0,2%					
Weight for m2	6 kg/m2 (100mm), 9 kg/m2 (200mm)					
Thermal conductivity λD W/m K	≤ 0.035)					
Thermal resistance (Rt) m² K/W	20 mm	30 mm	50 mm	100mm	150mm	200 mm
	0.55	0.85	1.45	2.85	4.30	5.70
Thermal Transmittance (U) W/ m² K	1.80	1.15	0.70	0.35	0.25	0.20
Functional and structural resistance to hard body shock	suitable					
Functional and structural resistance to soft body shock	suitable					
Structural resistance to eccentric vertical load	suitable					
Resistance to flexion Elasticity module	0.603 N/mm² - 54.16 N/mm²					
Axial Vertical load resistance	0.499 N/mm²					
Permeability to water vapor	0.001 mg/(Pa.h.m.)					
Water vapor diffusion resistance factor	716 μ					
Short term water absorption by partial immersion	0.30 Wp (Kg/m²)					
Response to fire DIN 4102 standard version	B1					
Response to fire EN 13501 standard version	SE					

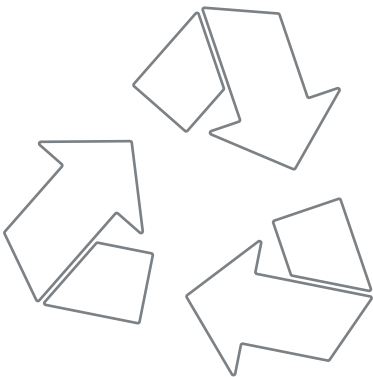



quickfoam Dimensions

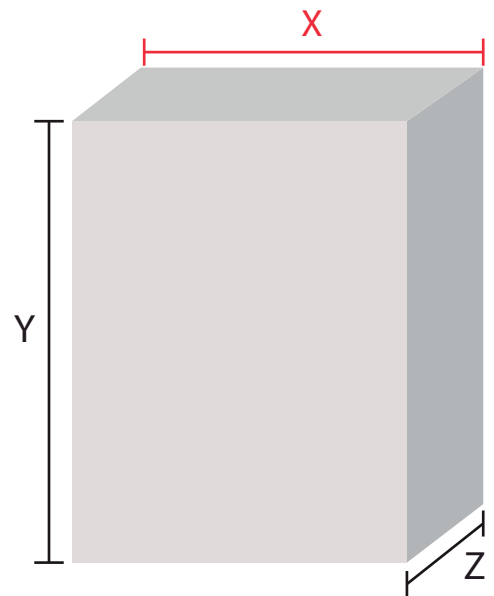
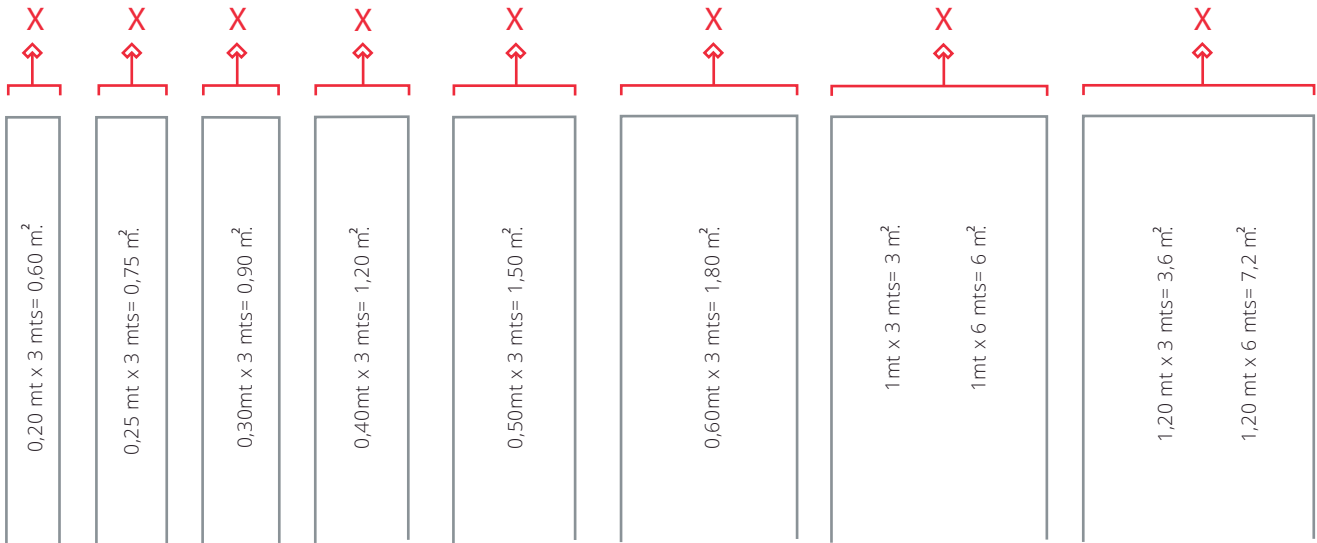



quicknessfoam Dimensions

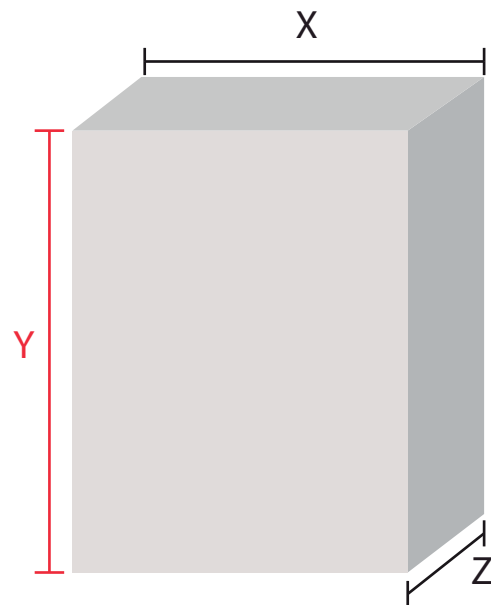
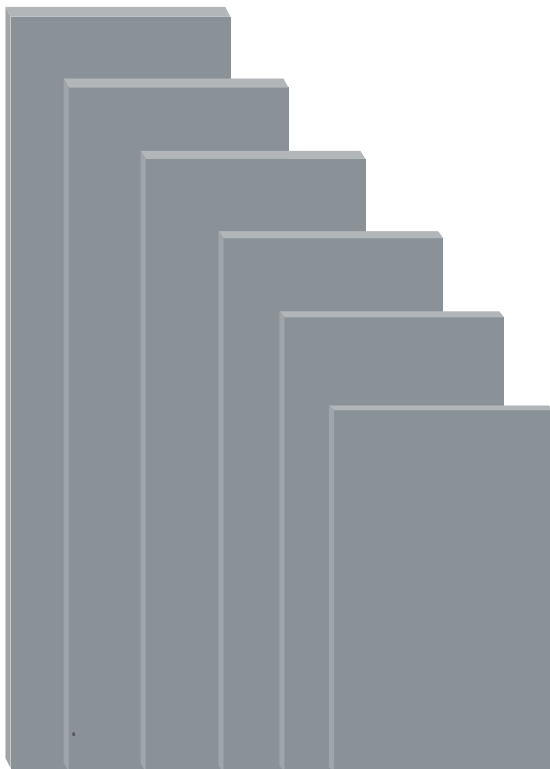
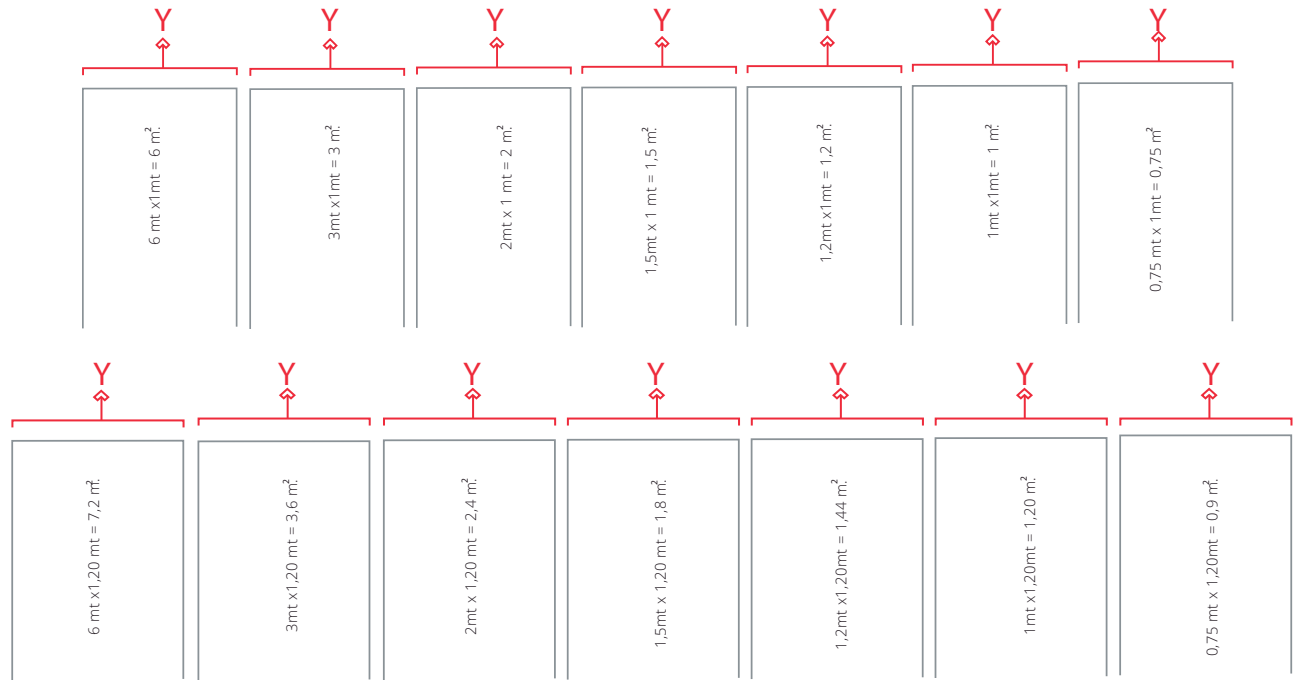



quickplack Dimensions

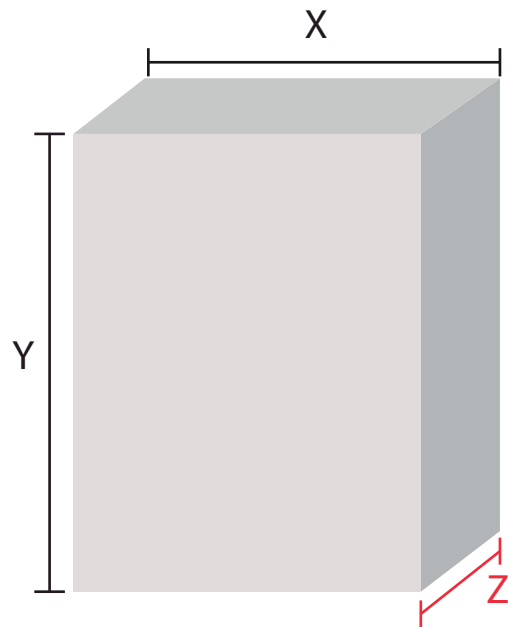
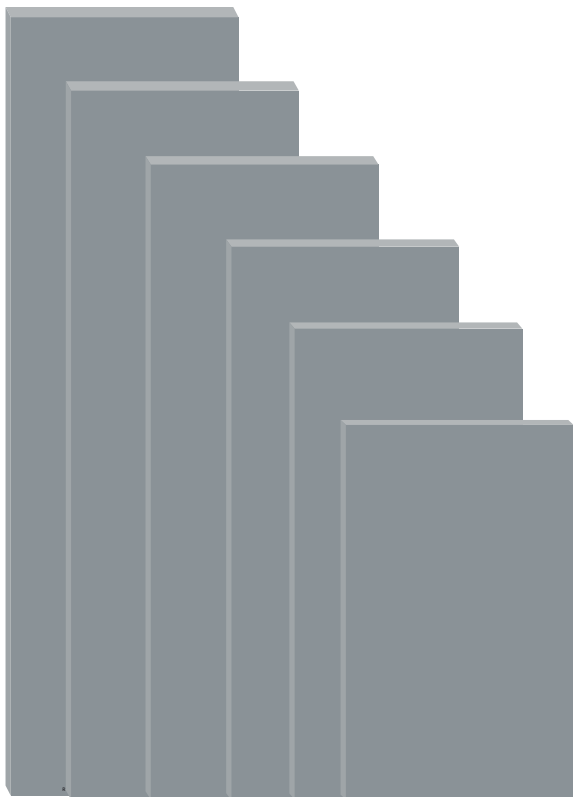
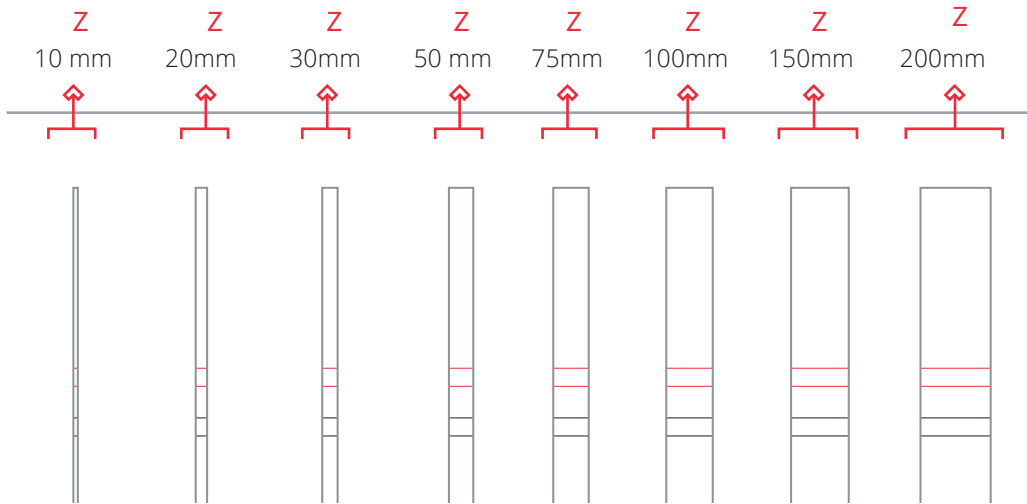

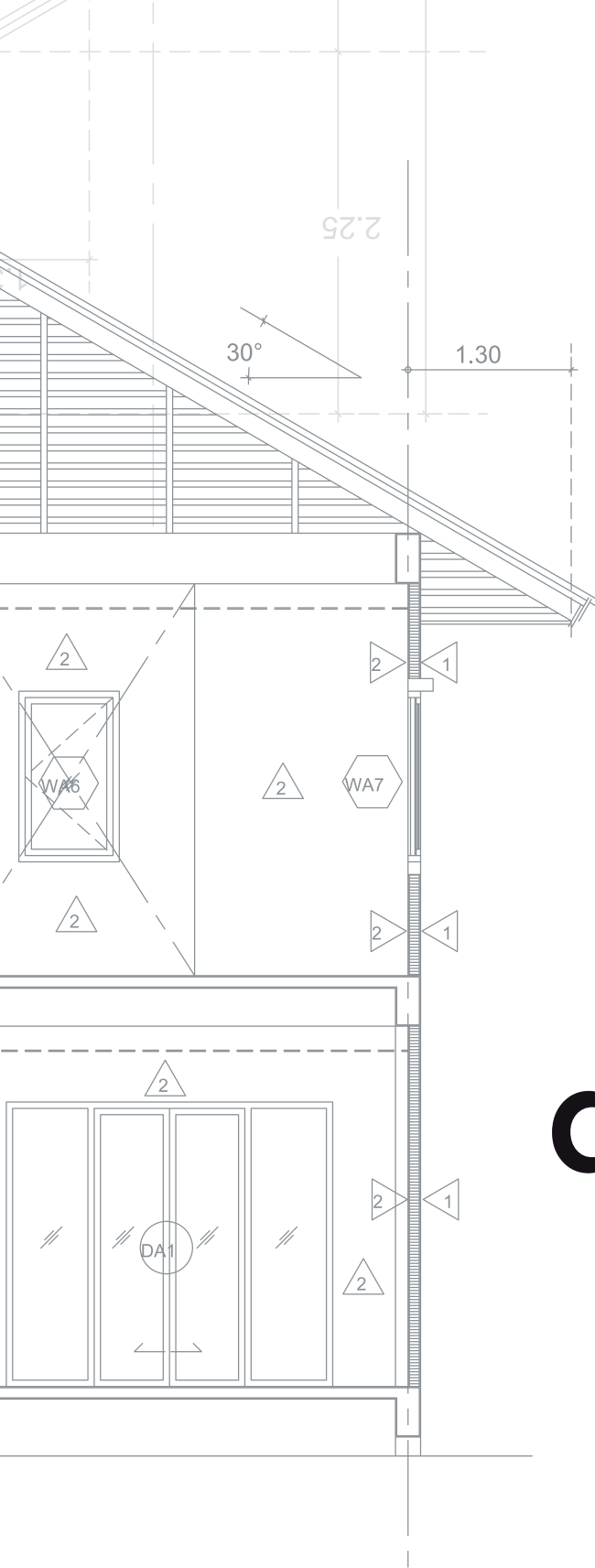

quickplack®

España

+34868128999

+34619199399

+34606852013

Panamá

+507 833 7662

Estados Unidos

+1 407 413 9329

quickplack@quickplack.com

www.quickplack.com